

Rev	Date	By	Description
A	-	MGS	-
B	-	MGS	-
C	13/09/22	MGS	Issued for Planning

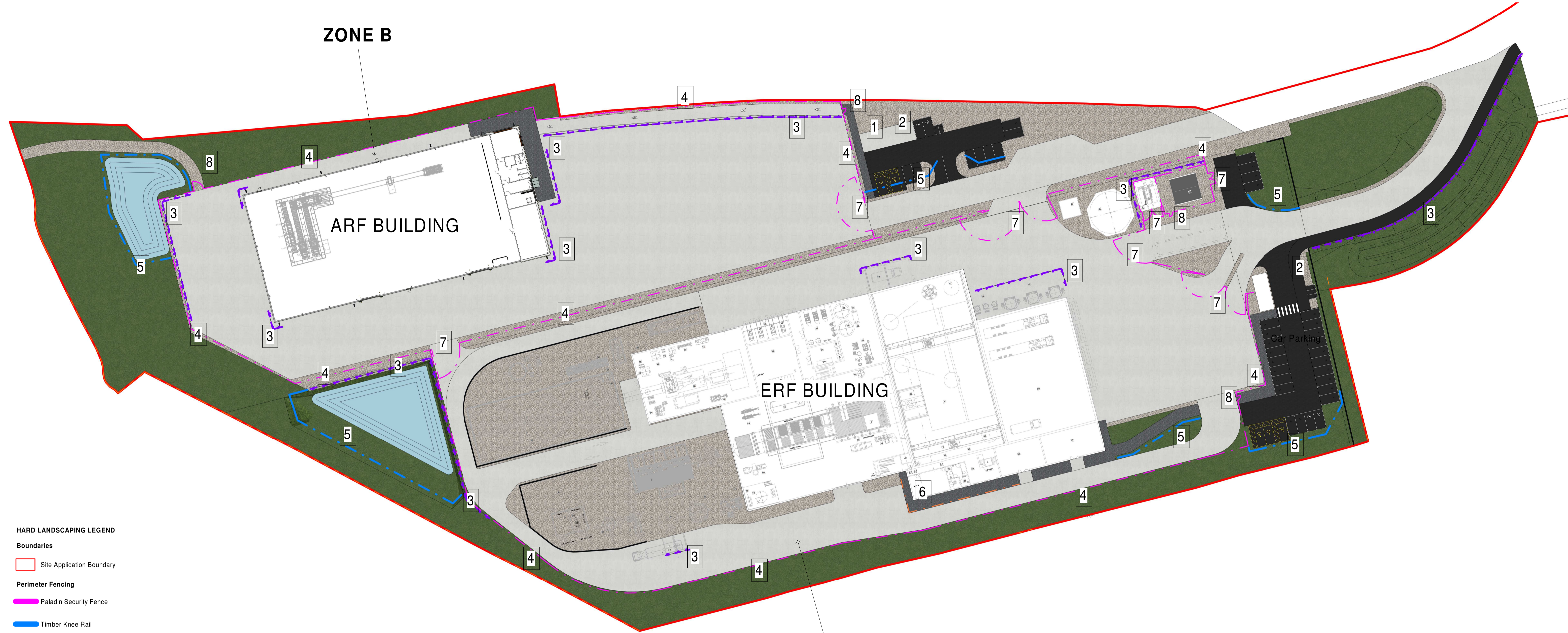

**HARD LANDSCAPING LEGEND**

**Boundaries**

Site Application Boundary

**Perimeter Fencing**

Paladin Security Fence

Timber Knee Rail

**External Hard Surfacing**

Concrete Service Yard construction

Flexible carriageway construction – macadam with concrete edgings & kerbs

Flexible footway/cycle lane construction - tarmacadam, combine cycle and pedestrian routes are clearly defined with white line markings. Key junctions to be defined with contrasting and tactile paving to part m building regulations.

Car parking bays - flexible macadam surfacing and white lines.

Pathways - 60mm thick contrast colour concrete block paving by Marshalls or a similar approved material to the office elevations and entrances. colour: light grey natural lay - herringbone.

Pathways - 600mm contrast colour paving slabs laid max 50mm sand on min 300mm hardcore, well vibrated, with joints filled with dry wash sand. Colour Grey

Gravel access construction

*Note: All hard surface construction and water course to engineers specification.*

Soft landscaping areas - refer to Landscape Architect's drawings.

Water Basins. Refer to to Engineers details and or Landscape Architect's drawings.

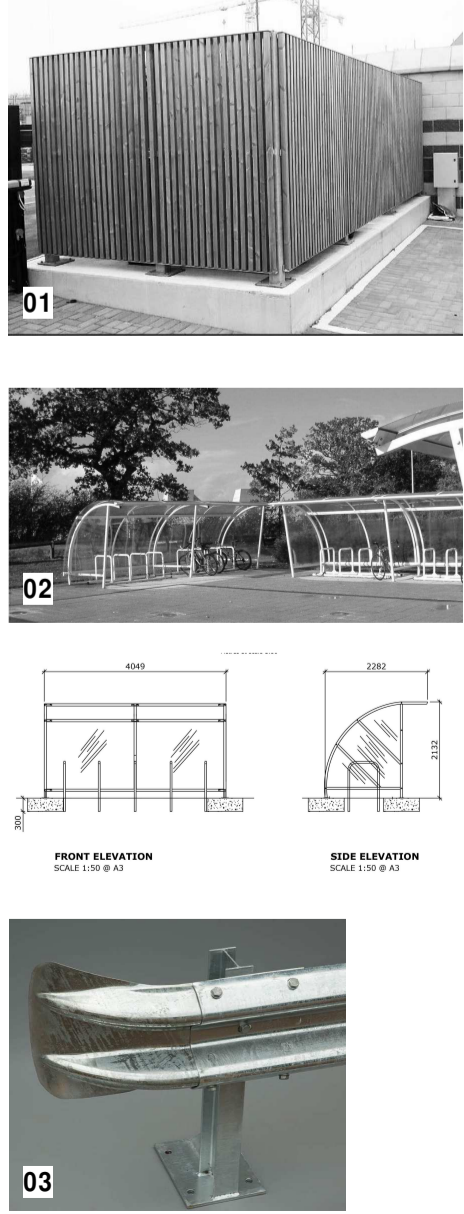

**01 WASTE MANAGEMENT STORE**  
Concrete base with 2.4m high timber close-board fencing with galvanized structure.

**02 BICYCLE STORE**  
Urban Engineering 'Series A' or similar and approved Polycarbonate transparent sheets with polyester powder coated steel frame.  
Colour: Black Sheffield steel cycle racks or similar and approved to accommodate 10 cycles per shelter.

Arrangement and quantity of Cycle Stands within the Cycle Store area in accordance with planning requirements

Refer to site plan for location and positioning.

**03 ARMCO BARRIER**  
Armco barrier galvanised mild steel. The barrier uprights are to be surface fixed to the concrete.

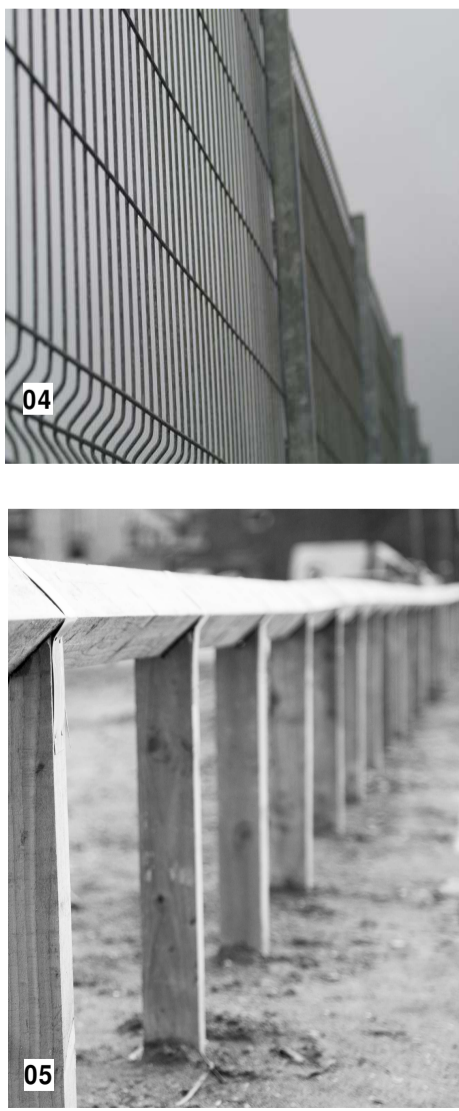

**04 BOUNDARY SECURITY FENCE**  
Typical Paladin Fencing:  
The perimeter of the service yards will be provided with 3m high paladin fencing. Post and panels to be black finish.  
Fences to be suitably set back from vehicular areas to reduce risk of accidental impact. Fencing / landscaping to be co-ordinated such that a maximum gap beneath fence is 100mm.

**05 KNEE RAIL FENCING**  
Made from treated softwood. Galvanised strap. Height 1.20m Planed finish.



**06 FIXED GUARDRAILS**  
Handrails and balustrading min. 1m high will be provided in circular hollow, hot dipped galvanised mild steel sections. Secures onto concrete retaining walls, to provide appropriate permanent protection from falls were necessary.

**07/08 VEHICLE AND PEDESTRIAN GATES:**  
To security sensitive areas near the main access road, vehicle gate is to be black steel paladin, 3m high to BS 1722-12:2006 (including concrete foundations). Gates to hinge open and be able to be held in the open position by providing bolt sleeves. Posts to be square section powder coated black steel with capped tops, cast in concrete bases.

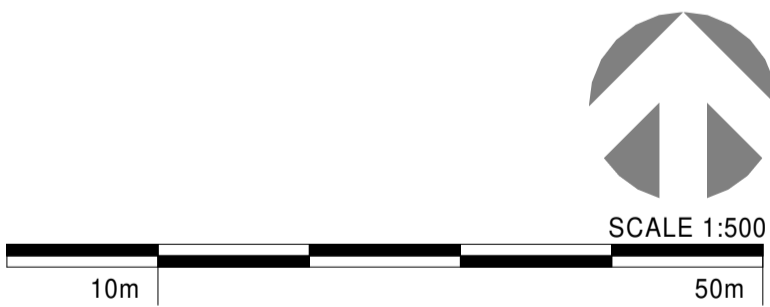

**SGP**

Architects + Masterplanners

Innovation Centre  
1 Devon Way  
Longbridge Technology Park  
Birmingham  
B31 2TS

t: +44 (0)121 222 5346

[www.stephengeorge.co.uk](http://www.stephengeorge.co.uk)

SRRP  
Swadlincote  
R & P Clean Power

Drawing Name:  
Planning\_SRRP\_Hard Landscaping, Fences, Gates and Barriers

Drawing Stage: **Planning**

Status: **S0**

SGP File Ref: 21-137-SGP-XX-DEV-M3-A-0001\_Site

21-137 10/06/22 RS RS As @ A1 C  
SGP Project No: Date: Drawn: Team: Indicate: Scale: Rev:

Drawing Number:  
21-137-SGP-01-ZZ-DR-A- 131003

Project Code Originator Volume Level Type Role Number